

Capless / Use and Care Guide <Retractable Type>

Nib Extension and Retraction

<Retractable Type>

- (1) Press the knob down until it clicks into place and the nib comes out. [Fig.1]
- (2) Press the knob again until it clicks to retract the nib. [Fig.1]

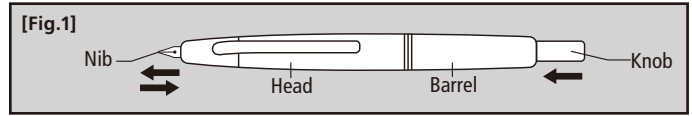

How to fill with ink

Cartridge type

| | | | |
|---|---|--|---|
| <p>① Barrel</p> | <p>② Head Penholder Ink cartridge cover</p> | <p>③ Penholder Ink cartridge cover</p> | <p>④ Ink Cartridge</p> |
| <p>First, ensure that the nib is retracted. Then, rotate the barrel in the direction of the arrow to remove it.</p> | <p>Hold the head and withdraw the penholder from the head.</p> | <p>Separate the ink cartridge cover from the penholder.</p> | <p>Hold the pen with the nib pointing upward and pull out the empty cartridge. Then, insert the new cartridge, making sure to insert it straight in. Twisting it during insertion may prevent the valve from opening.</p> |
| <p>⑤</p> | <p>⑥ Guide notch Square guide knob</p> | <p>⑦ Barrel</p> | |
| <p>Insert the ink cartridge cover into the penholder firmly.</p> | <p>Then insert the penholder into the head by sliding the penholder's square guide knob in the guide notch in line with the pen clip.</p> | <p>Insert the barrel into the head and turn it in the direction of the arrow to secure it.</p> | |

■ Converter type

<Rotation type Converter (CON-40)>

- (1) Hold the pen with the nib pointing upward and fully insert the converter. [Fig.2]
- (2) Rotate the converter knob in the direction of the arrow. [Fig.3]
(Handle the pen gently after wipe of ink in the nib with a soft cloth or similar material. Ink may spatter if the nib contains sufficient ink.)
- (3) As shown in Figure 4, dip the nib vertically into the ink up to the top of the neck. [Fig.4]
 - * Be careful not to hit the bottle with the nib point to protect the nib.
- (4) Fill the converter with ink by turning the knob in the direction of the arrow.[Fig.4]

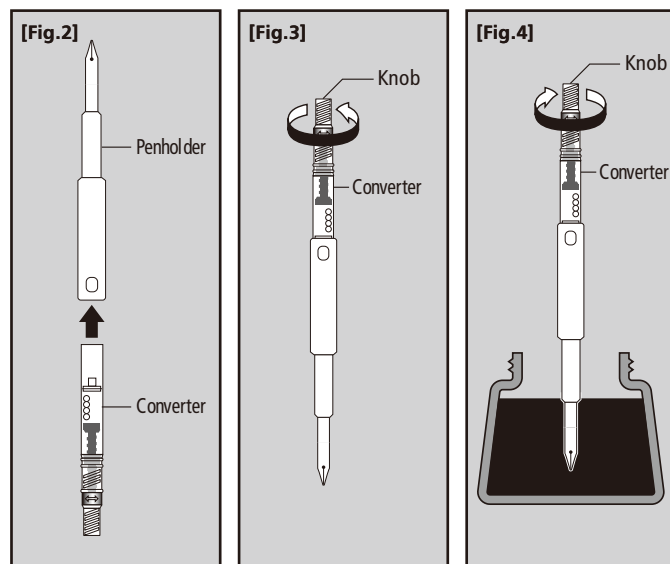

- * To replace the converter with an ink cartridge, first remove any remaining ink from the converter. Then hold the neck of the pen with the nib pointing up and slowly remove the converter by slightly pulling it straight or twisting it clockwise. Any ink remaining in the converter should be washed off with water. Dry the converter completely and store it.
- * It may be impossible to fill the converter with ink if the amount remaining in the bottle is low. Refill inks from bottles that have a sufficient amount of ink remaining.
- * Any ink on the nib or other parts should be wiped off with a soft cloth or similar material before use.

Care and Storage

- Keep the pen out of the reach of children and away from excessive heat, cold, or direct sunlight.
- If the pen is not used regularly, drain the ink from it. Then, clean the inside by filling and draining the pen with clean water several times.
- This pen contains custom-made precision parts. Do not try to repair it yourself.

Remarks

- Please do not use this product for any purpose other than writing.
- Keep away from children.
- After use always retract the nib.
- When starting to use a fountain pen for the first time, pinch the middle of the inserted cartridge with your fingers gently so that the ink flows down to the pen point.
- Prevent ink from spilling by pointing the nib upward when replacing a cartridge.
- When changing the ink
The lower part (A) of the penholder may occasionally become smudged with ink. (Smudging by ink on part (A) does not affect the fountain pen's performance.) Please hold the part (B) when refilling. [Fig.5]
- Cleaning the pen
Over longer periods of usage, the penholder may clog with ink sediment. Wash the pen with clean water occasionally.
 - * Please refrain from washing the head and barrel. This may cause a malfunction.
- Nib extension and retraction
Gently extend and retract the nib. If the nib is repeatedly extended and retracted or if the knob is suddenly retracted, causing a shock, ink may splatter or drip inside the pen. This may also result in excessive ink flow and smudging.
- Changes in air pressure may cause the ink to leak or gush out, so do not use this pen on a plane.
- Please use PILOT ink (cartridge or bottled) for PILOT fountain pens. Please note that mixing with other inks or old ink may cause problems.
- Note that it may not be possible to remove this ink if it accidentally gets on your clothes.
- Pilot's Tsuwaito pigment ink for fountain pens cannot be used on lacquerware, including maki-e products.
- Please avoid dropping the fountain pen or applying excessive force since the shock could cause it to malfunction.
- Please be warned that applying chemicals, including solvents, such as alcohol, causes cracks or discoloration.

